



Husqvarna launches new product ranges for Compaction and Concrete Placement.

The ink has hardly dried on the business deal with Atlas Copco, but Husqvarna Construction Products is already launching the new product range within light compaction and concrete placement. It will make Husqvarna an even more complete partner for its channel partners and end users.

Within short, Husqvarna's new tamping rammers, soil and asphalt plate compactors, reversible plate compactors, duplex rollers, concrete vibrators, screeds and trowels will be available at dealers and rental depots around the world.

Unique capabilities to benefit customers.

Entering the new market segment, Husqvarna will face a number of new strong competitors on the playing field. What will Husqvarna bring to the game?

"Husqvarna is known for its innovative ways of creating integrated systems that increase productivity and reduce cost of ownership" says Sebastian Pocard, Vice President at Husqvarna for Concrete Surfaces & Floors. "Servicing the light construction market is part of Husqvarna's DNA. With best-in-class innovation capabilities and a global network of sales and service points, we'll make it even easier

to use and own light compaction and concrete placement equipment".

End-to-end solutions for concrete surfaces and floors.

Another important success factor is that Husqvarna Construction Products already offers one of the market's leading product ranges in concrete sawing, drilling, grinding and polishing, and dust and slurry management. By broadening the product range to also encompass prior process steps, Husqvarna now offers a complete solution for the entire process from ground compaction to a polished concrete floor, for the benefit of channel partners and end users around the world.

"This is something unique that only Husqvarna can offer", Sebastian Pocard concludes.



The new compaction range from Husqvarna includes tamping rammers, reversible plate compactors, forward plate compactors for soil and asphalt, and duplex rollers.

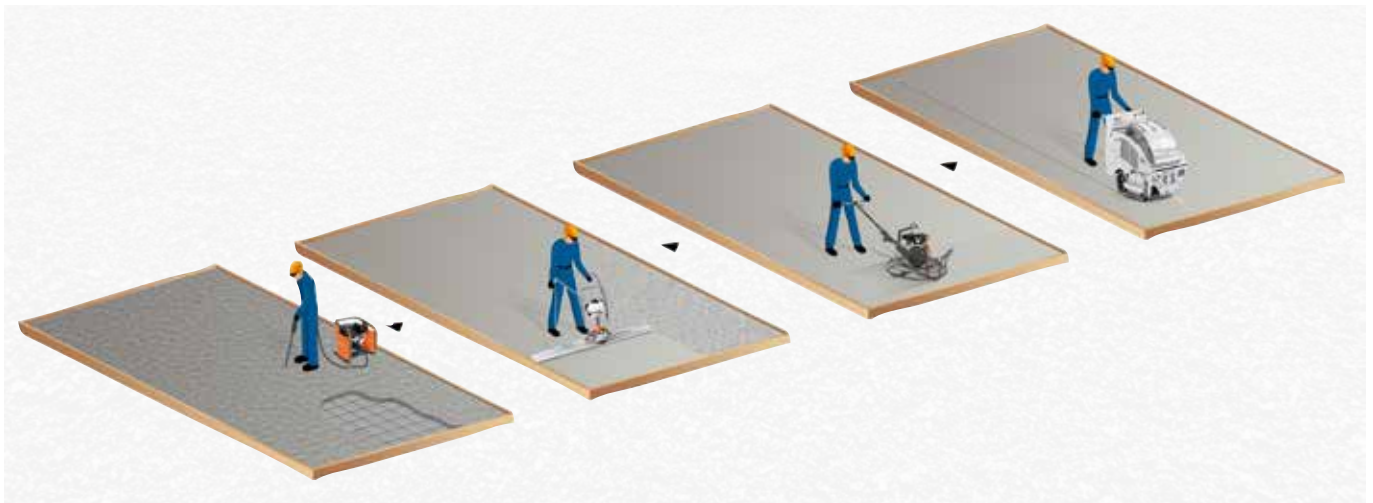

The new concrete placement equipment range from Husqvarna includes internal vibrators, screeds and trowels. Soff-Cut early entry saws are already part of Husqvarna's total offer.

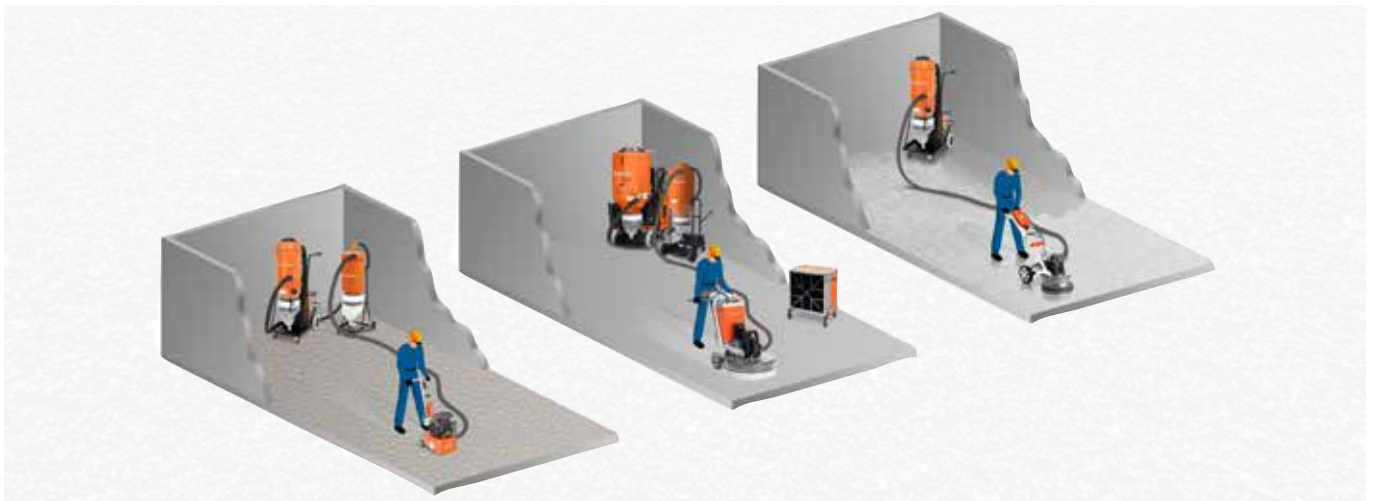

Husqvarna's range of surface preparation equipment and dust and slurry management systems adds to a complete solution for the entire process from soil compaction to a finished concrete floor.

For more information, please contact:

Catherine König, Global Marketing Director, Husqvarna Concrete Surfaces & Floors
 catherine.konig@husqvarnagroup.com

www.husqvarnacp.co.uk

Follow us!

 facebook.com/HusqvarnaConstructionUK

 youtube.com/husqvarnacp

HUSQVARNA CONSTRUCTION PRODUCTS, part of Husqvarna Group, is a market leader in machines and diamond tools for the construction and stone industries. The product range includes power cutters, drill motors and drill stands, diamond tools, floor, masonry, wall and wire saws, as well as light compaction and concrete placement equipment, surface preparation and demolition machines. Net sales 2017 amounted to 5 billion SEK. Husqvarna Construction Products has 2,100 employees, 11 major factories around the world and is represented in more than 70 countries. Husqvarna is a registered trademark owned by Husqvarna AB (publ).